

Denali D2 LED Driving Lights

TT-D2.KIT Instruction Rev: 00

PLEASE READ BEFORE INSTALLING

TWISTED THROTTLE products should be installed by a qualified, experienced motorcycle technician. If you are unsure of your ability to properly install a product, please have the product installed by your local motorcycle dealer. TWISTED THROTTLE takes no responsibility for damages caused by improper installation.

All screws, bolts, and nuts, including all replacement hardware provided by TWISTED THROTTLE should be tightened to the torque specified in the OEM maintenance manual for your motorcycle. If no torque specifications are provided in the OEM maintenance manual, the following torques may be used:

M5.....	3.5 ft-lbs (5 Nm)
M6.....	7 ft-lbs (9.6 Nm)
M8.....	13 ft-lbs (18 Nm)

All screws, bolts, and nuts should be checked after driving the first 30 miles (50 km) to ensure that all are tightened to the proper torque.

Medium strength liquid thread-locker (i.e., "Loctite") should be used to secure all screws, bolts, and nuts.

Twisted Throttle LLC
1080 Kingstown Rd, Building 1
Peace Dale, RI 02879

phone: 401.284.4200
fax: 401.223.6955
www.twistedthrottle.com

WARNING! – Only use the included wiring harness to wire Denali lights. Even though the plug may be similar to other wiring, Denali lights have unique circuitry that can easily be damaged by using wiring other than the included harness.

Kit Contents

1
D2 LED light Pod

20° Lens Installed
Qty.....2

2
Hinge Link

Qty.....2

3
Socket Head Screw

M3x20.....DIN 912
Qty.....2

4
40° Fog Lenses

Qty.....2

5
"U" Bracket Hinge

Qty.....2

6
Hex Head Screw

M6x35.....DIN 933
Qty.....2

7
Lock Nut (M6)

M6.....DIN 985
Qty.....2

8
Hex Head Screw

M10x20.....DIN 933
Qty.....2

9
Lock Nut (M10)

M10.....DIN 985
Qty.....2

10
Nut Cap (M10)

Qty.....2

11
Wiring Harness

Qty.....1

12
Posi-tap Connector

Qty.....2

13
Allen Key

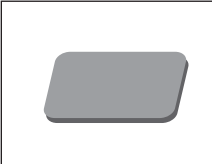
2.5mm
Qty.....1

14
Zip Tie

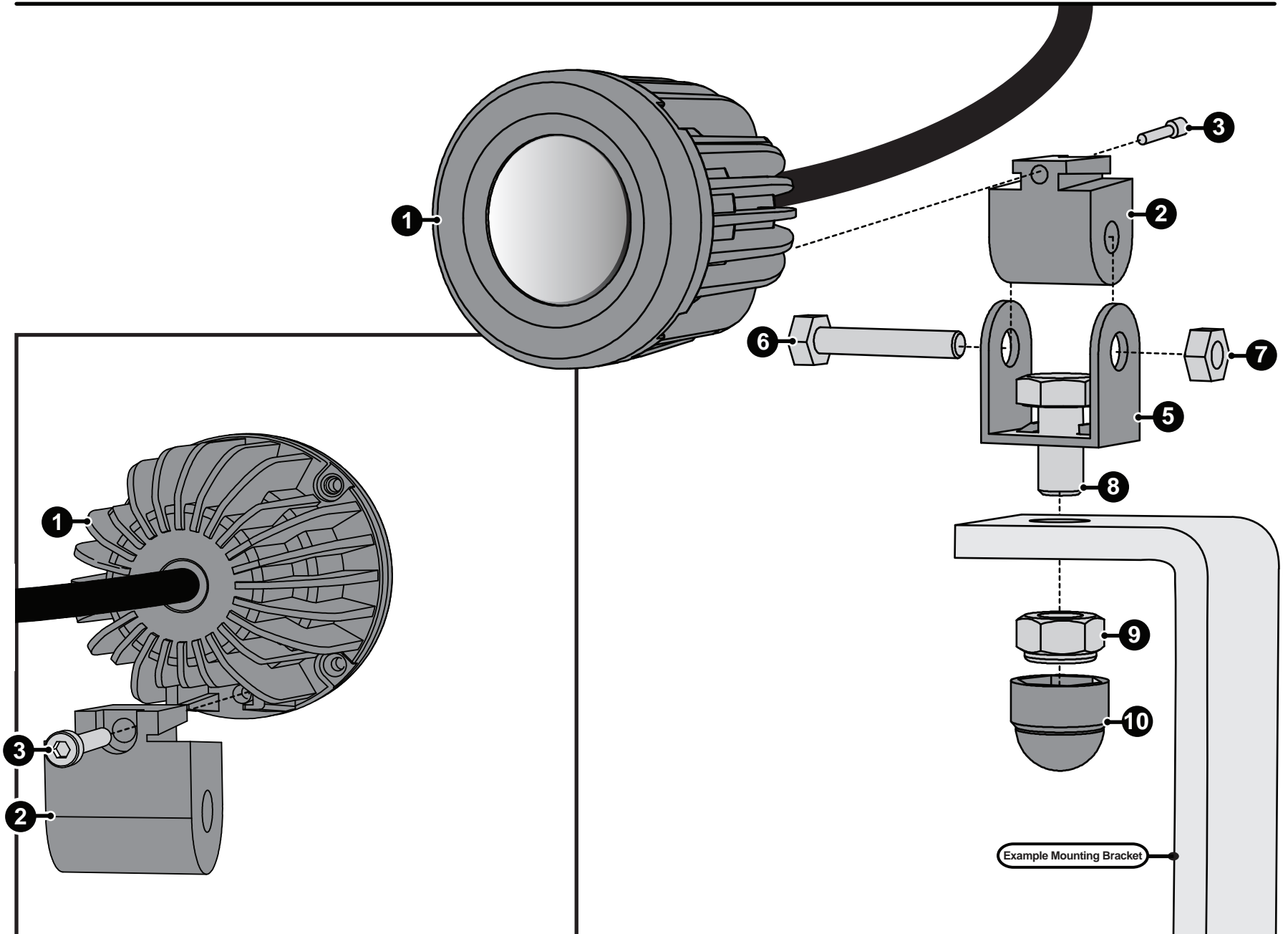
Black
Qty.....4

15
Double Stick Mount

Qty.....1

Mounting Instructions



Wiring Instructions

Wiring Option One:

Standard Dual Intensity (high and low)

Function:

In this wiring configuration, Denali D2 lights will function perfectly in sync with your original headlight. The D2 low beam (40% intensity) will come on when your motorcycle is turned on, and the D2 high beam (100% intensity) will come on when you switch your high beams on. To turn the D2 light system off entirely, simply press the lighted on/off switch.

How to Wire:

(1) Attach the positive and negative ring terminals to the battery.

(2) Identify the **white** wire (switched power) . Use one posi-tap connector to tap the white wire into the motorcycles low beam headlight wire or any switched 12 volt power wire (a rear running light wire or dash light wire would also work)

(3) Identify the **blue** wire (100% intensity trigger). Use one posi-tap connector to tap the blue wire into the high beam headlight wire of your motorcycle.

(4) Connect the D2 Lights and mount the switch. Check to make sure they are functioning properly. Make sure all wires and switch are properly routed from the battery to the lights avoiding hot surfaces, sharp objects, and moving parts.

Note: Universal and bike specific mounting kits are available at twistedthrottle.com. Additional wiring options are possible. Visit twistedthrottle.com/denalid2 to view an installation tutorial.

Wiring Diagram (Full Intensity)

Note: This drawing is not to scale. Components are enlarged for illustrative purposes only.

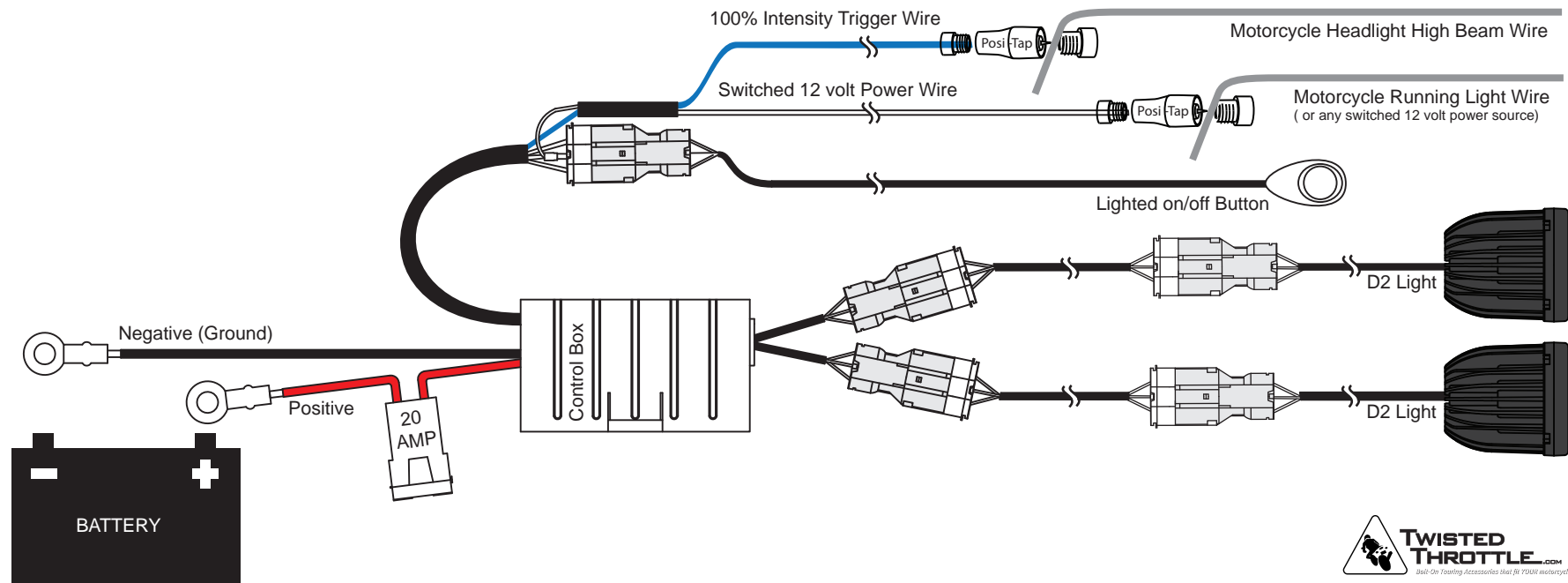

DENALI // D2 LED Dual Intensity Driving Lights // TT-D2.KIT

WARNING! – If mounting the lights to the front fender, forks, or fairing, turn the handlebars fully left and right and fully compress & uncompress the suspension to ensure the wires will not bind and have enough slack for your motorcycle to operate properly.

Wiring Instructions

Wiring Option Two: Full Intensity (no low beam)

Function:

In this wiring configuration, Denali D2 lights will function at 100% intensity (high beam) independent of your motorcycle's original headlight. The integrated switch will allow you to turn your D2 lights on and off at 100% intensity only.

How to Wire:

(1) Attach the positive and negative ring terminals to the battery.

(2) Identify the **white** wire (switched power) and the **blue** wire (100% intensity trigger).

(3) Twist the exposed ends of the two wires together, then fasten both wires through the small end of one posi-tap connector. Tap the combined blue and white wire into the motorcycle's low beam headlight wire or any switched 12 volt power wire (a rear running light wire or dash light wire would also work).

(4) Connect the D2 Lights and mount the switch. Check to make sure they are functioning properly. Make sure all wires and switch are properly routed from the battery to the lights, avoiding hot surfaces, sharp objects, and moving parts. If mounting the lights to the front fender, forks, or fairing, turn the handlebars fully left and right and fully compress & uncompress the suspension to ensure the wires will not bind and have enough slack for your motorcycle to operate properly.

Note: Universal and bike specific mounting kits are available at twistedthrottle.com. Additional wiring options are possible. Visit twistedthrottle.com/denali2 to view an installation tutorial.

Wiring Diagram (Full Intensity)

Note: This drawing is not to scale. Components are enlarged for illustrative purposes only.

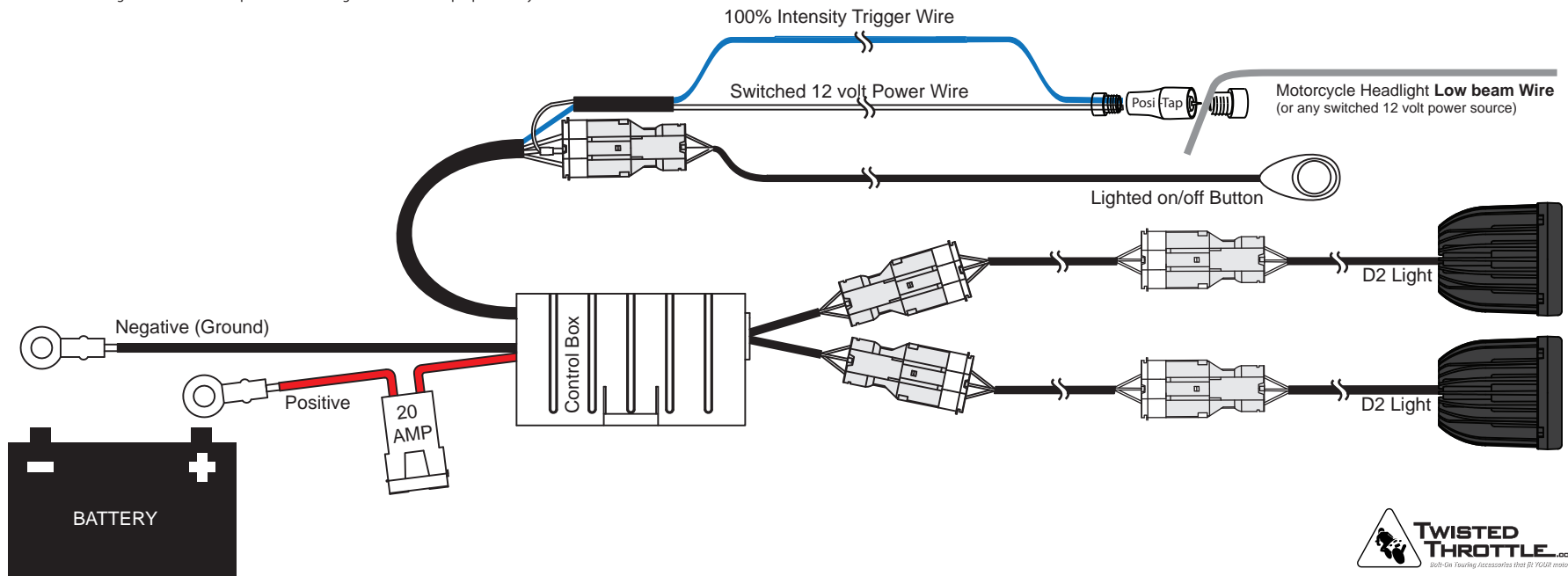

DENALI // D2 LED Dual Intensity Driving Lights // TT-D2.KIT



WARNING! – If mounting the lights to the front fender, forks, or fairing, turn the handlebars fully left and right and fully compress & uncompress the suspension to ensure the wires will not bind and have enough slack for your motorcycle to operate properly.